

Apex Sketch v7

Deleting an Area

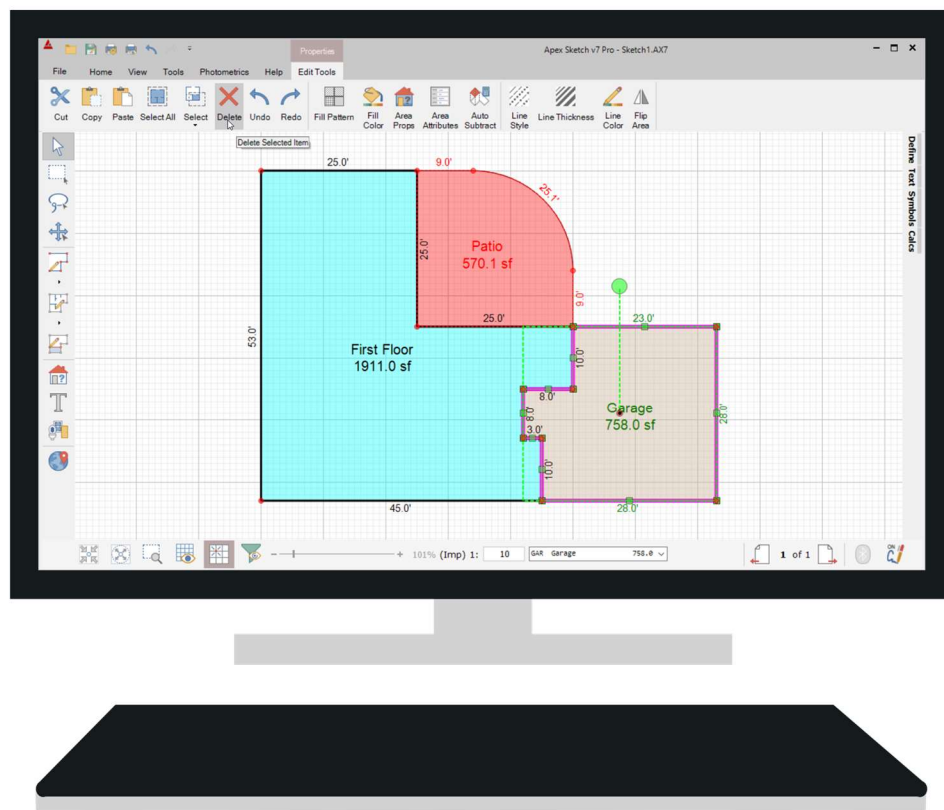

Apex Sketch Version 7 – Deleting an Area

To make any Edits in Apex v7 you will first need to ensure the **Pointer** tool is selected. Click on the Pointer icon located at the top of the Drawing Toolbar if it is not already selected.

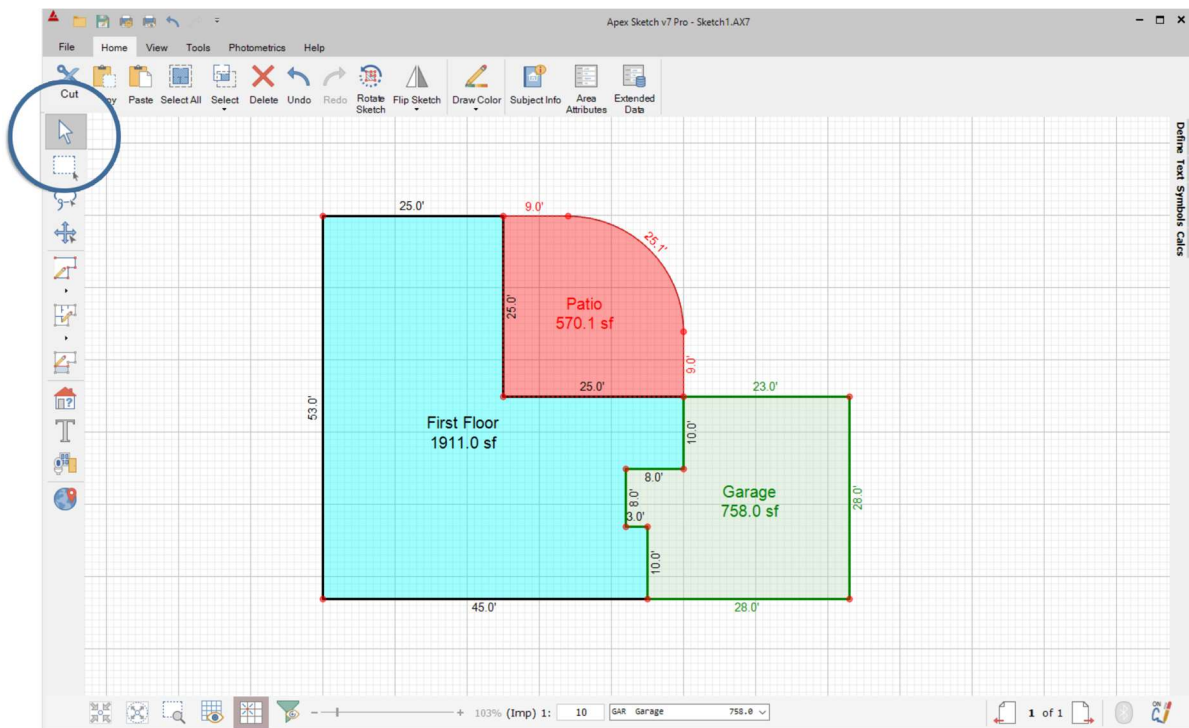

With the **Pointer** Tool enabled, click inside the Area you want to remove from the sketch. The Area will become highlighted in **Purple** indicating it can be moved, edited, or deleted.

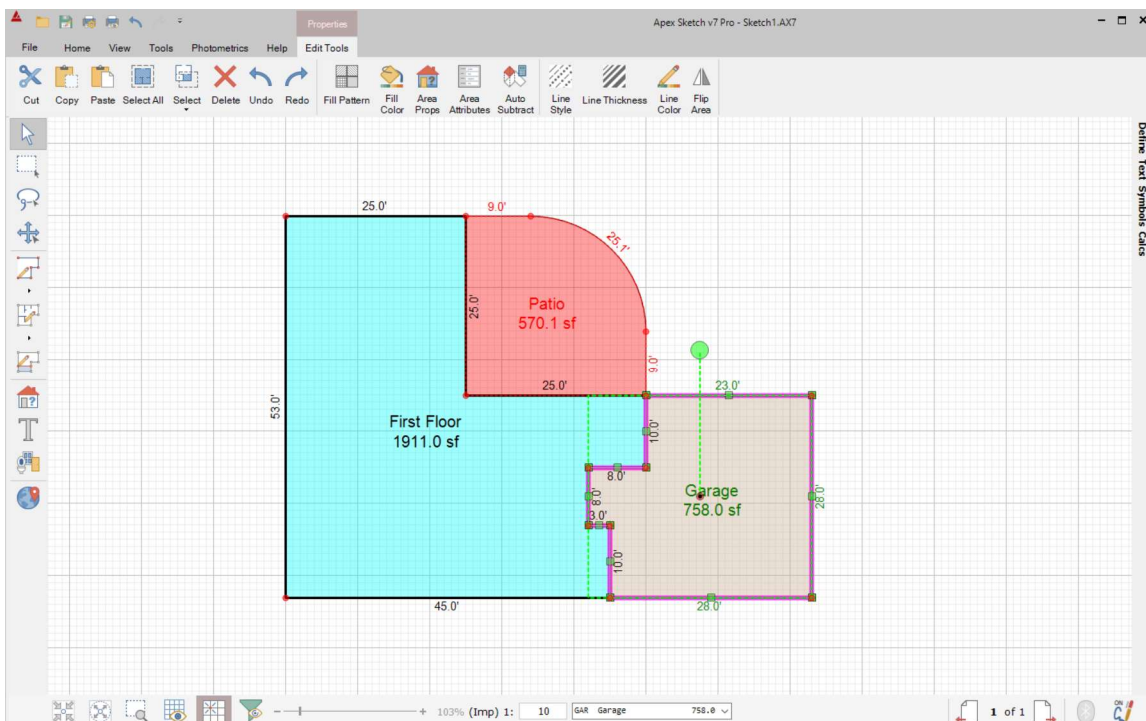

Note: Make sure you have selected the Area, NOT the auto-post label(s) and/or a perimeter line.

Deleting an Area (continued)

With the Area you would like to remove from the sketch selected, tap the [Delete](#) key on your keyboard to remove the selected Area from the sketch.

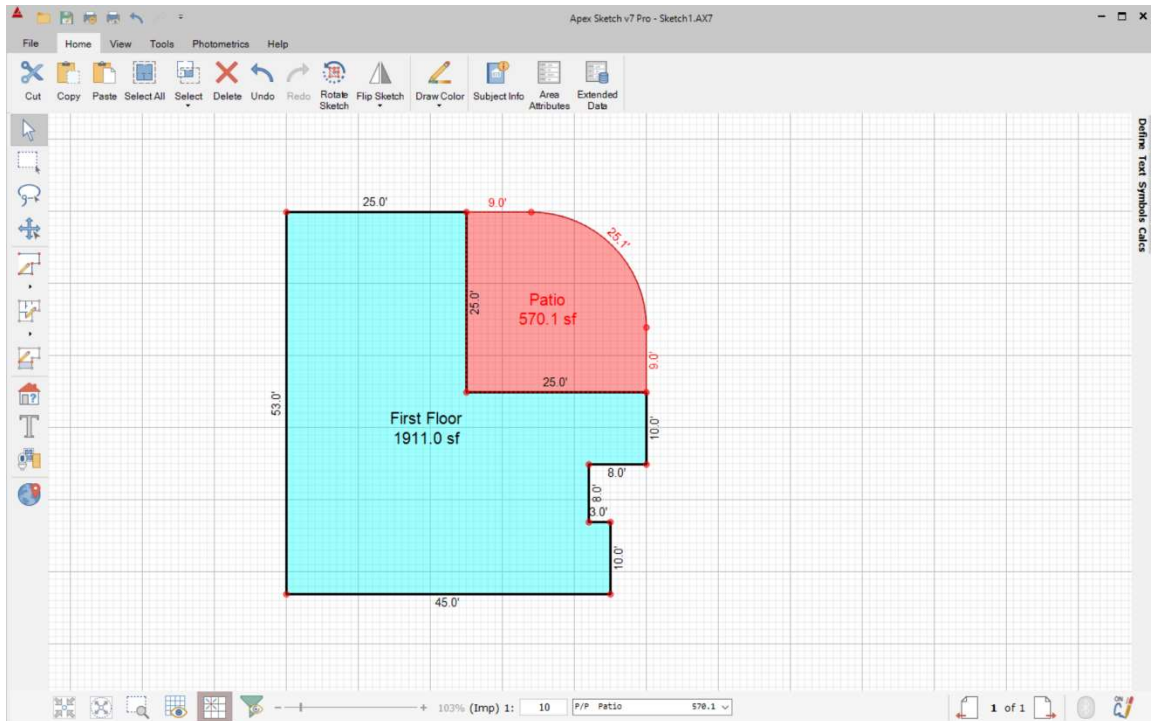

Note: You can also click on the Delete button in the Ribbon Bar to delete the selected area.
